

# ET1 攻牙筒夹

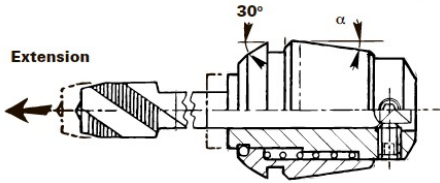

- 瑞士制造
- 最有经济效益，筒夹具轴向补偿机构
- 外形符合ER和ESX，即DIN 6499与ISO 15488，可与该筒夹通用
- 短、中、长的刀柄皆可以使用
- 弹簧力依据攻牙尺寸
- 刚性好、外型轻巧和对中心准确
- 可以保证螺纹深度
- ET1-12与ER11相容



# PCM ET1

DIN 6499/ ISO 15488  
(ER / ESX, 8°)

| 柄径Ø<br>[mm] | ET1-12<br>编号 | ET1-16<br>编号 | ET1-20<br>编号 | ET1-25<br>编号 | ET1-32<br>编号 | ET1-40<br>编号 | ET1-50<br>编号 | ISO<br>DIN<br>Japan |
|-------------|--------------|--------------|--------------|--------------|--------------|--------------|--------------|---------------------|
| 1.00        | ET1-12100AL  | ET1-16100AL  |              |              |              |              |              |                     |
| 1.40        | ET1-12140    | ET1-16140    |              |              |              |              |              | D                   |
| 1.50        | ET1-12150AL  | ET1-16150AL  |              |              |              |              |              |                     |
| 1.60        | ET1-12160    | ET1-16160    |              |              |              |              |              | D                   |
| 1.80        | ET1-12180    | ET1-16180    |              |              |              |              |              | D                   |
| 2.00        | ET1-12200    | ET1-16200    |              |              |              |              |              | (I)                 |
| 2.20        | ET1-12221    | ET1-16221    | ET1-20221    |              |              |              |              | D                   |
| 2.24        | ET1-12224    | ET1-16224    | ET1-20224    |              |              |              |              | I                   |
| 2.50        | ET1-12250    | ET1-16250    | ET1-20250    | ET1-25250    |              |              |              | I/D                 |
| 2.80        | ET1-12280    | ET1-16280    | ET1-20280    | ET1-25280    |              |              |              | I/D                 |
| 3.00        | ET1-12300    | ET1-16300    | ET1-20300    | ET1-25300    |              |              |              | J                   |
| 3.15        | ET1-12315    | ET1-16315    | ET1-20315    | ET1-25315    |              |              |              | I                   |
| 3.50        | ET1-12350    | ET1-16350    | ET1-20350    | ET1-25350    |              |              |              | D                   |
| 3.55        | ET1-12355    | ET1-16355    | ET1-20355    | ET1-25355    |              |              |              | I                   |
| 4.00        |              | ET1-16400    | ET1-20400    | ET1-25400    |              |              |              | I/D/J               |
| 4.50        |              | ET1-16450    | ET1-20450    | ET1-25450    | ET1-32450    |              |              | I/D                 |
| 5.00        |              | ET1-16500    | ET1-20500    | ET1-25500    | ET1-32500    |              |              | I/J                 |
| 5.50        |              | ET1-16550    | ET1-20550    | ET1-25550    | ET1-32550    |              |              | (D)/J               |
| 5.60        |              | ET1-16560    | ET1-20560    | ET1-25560    | ET1-32560    |              |              | I                   |
| 6.00        |              | ET1-16600    | ET1-20600    | ET1-25600    | ET1-32600    | ET1-40600    |              | D/J                 |
| 6.20        |              | ET1-16620    | ET1-20620    | ET1-25620    | ET1-32620    | ET1-40620    |              | J                   |
| 6.30        |              | ET1-16630    | ET1-20630    | ET1-25630    | ET1-32630    | ET1-40630    |              | I                   |
| 7.00        |              |              | ET1-20700    | ET1-25700    | ET1-32700    | ET1-40700    |              | D/J                 |
| 7.10        |              |              |              | ET1-25710    | ET1-32710    | ET1-40710    |              | I                   |
| 8.00        |              |              |              | ET1-25800    | ET1-32800    | ET1-40800    |              | I/D/(J)             |
| 8.50        |              |              |              | ET1-25850    | ET1-32850    | ET1-40850    |              | J                   |
| 9.00        |              |              |              | ET1-25900    | ET1-32900    | ET1-40900    |              | I/D                 |
| 10.00       |              |              |              | ET1-25100    | ET1-32100    | ET1-40100    |              | I/D                 |
| 10.50       |              |              |              |              | ET1-32105    | ET1-40105    |              | J                   |
| 11.00       |              |              |              |              | ET1-32110    | ET1-40110    |              | D                   |
| 11.20       |              |              |              |              | ET1-32112    | ET1-40112    |              | I                   |
| 12.00       |              |              |              |              | ET1-32120    | ET1-40120    |              | D                   |
| 12.50       |              |              |              |              | ET1-32125    | ET1-40125    |              | I/J                 |
| 14.00       |              |              |              |              |              | ET1-40140    |              | I/D/J               |
| 15.00       |              |              |              |              |              | ET1-40150    |              | J                   |
| 16.00       |              |              |              |              |              | ET1-40160    |              | I/D                 |
| 17.00       |              |              |              |              |              | ET1-40170    |              | J                   |
| 18.00       |              |              |              |              |              |              | ET1-50180    | I/D                 |
| 20.00       |              |              |              |              |              |              | ET1-50200    | I/D/J               |
| 22.00       |              |              |              |              |              |              | ET1-50220    | D                   |

- 筒夹具轴向补偿
- 用在柔性攻牙，攻牙面完整，不易伤丝攻
- 另外具有英制Inch柄

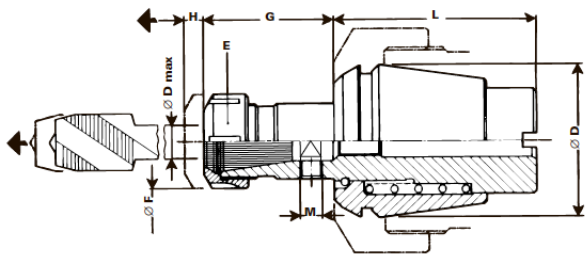

# ETU1

DIN 6499/ ISO 15488

| PCM型号        | 能力        | D  | E             | F  | G  | H  | L  | D max | M           |
|--------------|-----------|----|---------------|----|----|----|----|-------|-------------|
| ETU1-25-E11L | M1 - M3   | 26 | ER11<br>ESX12 | 16 | 16 | 8  | 32 | 7     | -           |
| ETU1-25-E11M | M3 - M5   |    |               |    |    |    |    |       | -           |
| ETU1-25-E11S | M6 - M10  |    |               |    |    |    |    |       | -           |
| ETU1-32-E11L | M1 - M3   | 33 | ER11<br>ESX12 | 18 | 32 | 10 | 41 | 7     | 2 x M6 x 06 |
| ETU1-32-E11M | M3 - M5   |    |               |    |    |    |    |       | 2 x M6 x 06 |
| ETU1-32-E11S | M6 - M10  |    |               |    |    |    |    |       | 2 x M6 x 06 |
| ETU1-32-E20L | M2 - M4   | 33 | ER20<br>ESX20 | 35 | 48 | 10 | 41 | 13    | 2 x M6 x 10 |
| ETU1-32-E20M | M5 - M8   |    |               |    |    |    |    |       | 2 x M6 x 10 |
| ETU1-32-E20S | M10 - M16 |    |               |    |    |    |    |       | 2 x M6 x 10 |
| ETU1-40-E16L | M2 - M4   | 41 | ER16<br>ESX16 | 27 | 40 | 13 | 53 | 10    | 2 x M6 x 08 |
| ETU1-40-E16M | M5 - M6   |    |               |    |    |    |    |       | 2 x M6 x 08 |
| ETU1-40-E16S | M8 - M12  |    |               |    |    |    |    |       | 2 x M6 x 08 |
| ETU1-40-E25L | M3 - M6   | 41 | ER25<br>ESX25 | 42 | 57 | 13 | 53 | 16    | 2 x M8 x 12 |
| ETU1-40-E25M | M8 - M12  |    |               |    |    |    |    |       | 2 x M8 x 12 |
| ETU1-40-E25S | M14 - M20 |    |               |    |    |    |    |       | 2 x M8 x 12 |

- 专为较小丝攻设计，只需换筒夹可装夹多种尺寸的丝攻
- 同一尺寸ETU1攻牙筒夹，根据丝攻大小，可分为强、中、弱三种弹簧
- 与ER和ESX筒夹相容，可互换

## 冲头柄 2100 系列

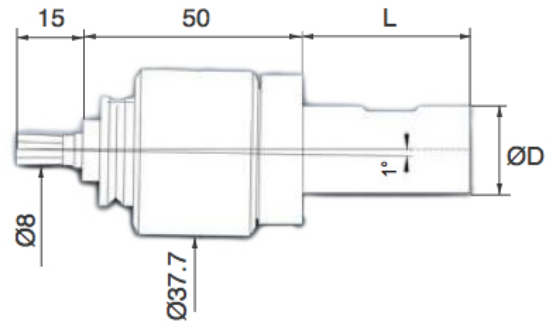
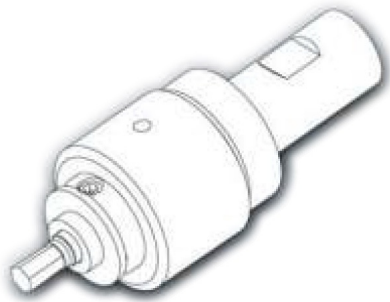

| PCM编号   | D [mm] | L [mm] |
|---------|--------|--------|
| 2100-58 | 15.87  | 38     |
| 2100-16 | 16     | 38     |
| 2102    | 19.05  | 38     |
| 2101    | 20     | 38     |

| PCM编号      | D [mm] | L [mm] |
|------------|--------|--------|
| 2103       | 25     | 50     |
| 2104       | 25.4   | 50     |
| 2100-22-75 | 22     | 75     |

- 挟持冲子Ø8 mm
- 最大推力1000 dan

## 2160 系列

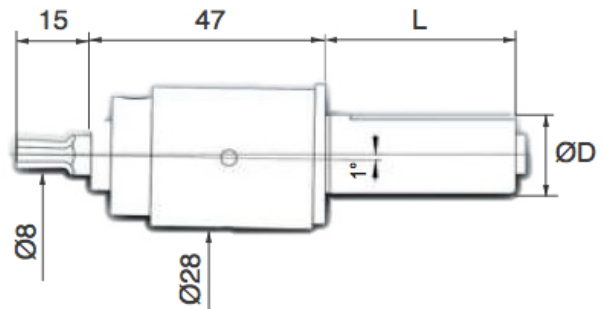
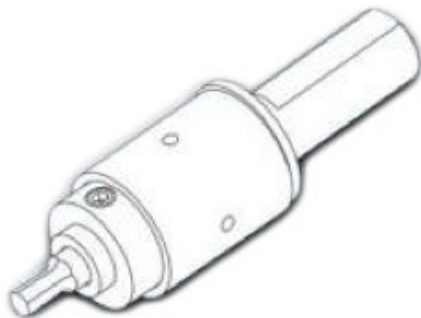

| PCM编号        | D [mm] | L [mm] |
|--------------|--------|--------|
| 2160-120-038 | 12     | 38     |
| 2160-140-038 | 14     | 38     |
| 2160-158-038 | 15.875 | 38     |
| 2160-160-038 | 16     | 38     |

| PCM编号         | D [mm] | L [mm] |
|---------------|--------|--------|
| 2160-190-100* | 19.05  | 100    |
| 2160-200-100* | 20     | 100    |
| 2160-220-100* | 22     | 100    |
| 2160-250-120* | 25     | 120    |
| 2160-254-120* | 25.4   | 120    |

- 挟持冲子Ø8 mm
- 最大推力1000 dan

- \*柄部长度可自行裁切

# 冲头柄

## 6180/ 6181/ 26200 系列

- 挟持冲子Ø8 mm
- 最大推力1200 dan

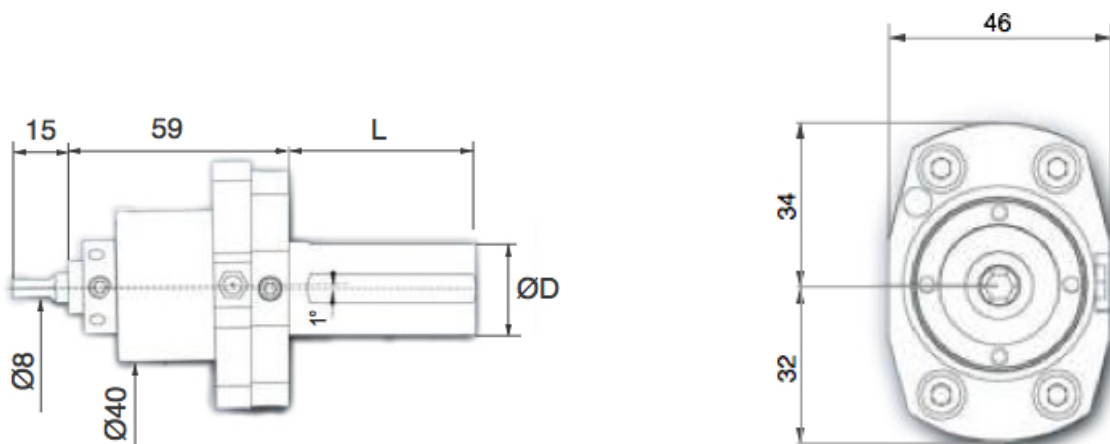
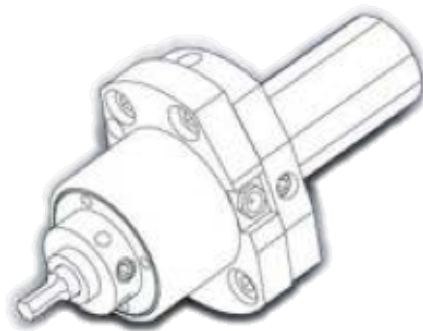

直柄

| PCM编号    | D [mm] | L [mm] |
|----------|--------|--------|
| 6180-158 | 15.87  | 40     |
| 6180-160 | 16     | 40     |
| 6180-190 | 19.05  | 40     |
| 6180-200 | 20     | 40     |
| 6180-250 | 25     | 50     |
| 6180-254 | 25.4   | 50     |
| 6180-300 | 30     | 60     |
| 6180-317 | 31.75  | 60     |
| 6180-320 | 32     | 60     |

直柄/兩平面

| PCM编号    | D [mm] | L [mm] |
|----------|--------|--------|
| 6181-158 | 15.87  | 40     |
| 6181-160 | 16     | 40     |
| 6181-190 | 19.05  | 40     |
| 6181-200 | 20     | 40     |
| 6181-220 | 22     | 40     |
| 6181-250 | 25     | 50     |
| 6181-254 | 25.4   | 50     |
| 6181-300 | 30     | 60     |
| 6181-317 | 31.75  | 60     |
| 6181-320 | 32     | 60     |

VDI 3425-2 / DIN 69880

| PCM编号    | VDI |
|----------|-----|
| 26200-16 | 16  |
| 26201    | 20  |

# 冲头柄

## 6190/ 6191/ 26300 系列

- 挟持冲子Ø8 mm
- 最大推力4000 dan

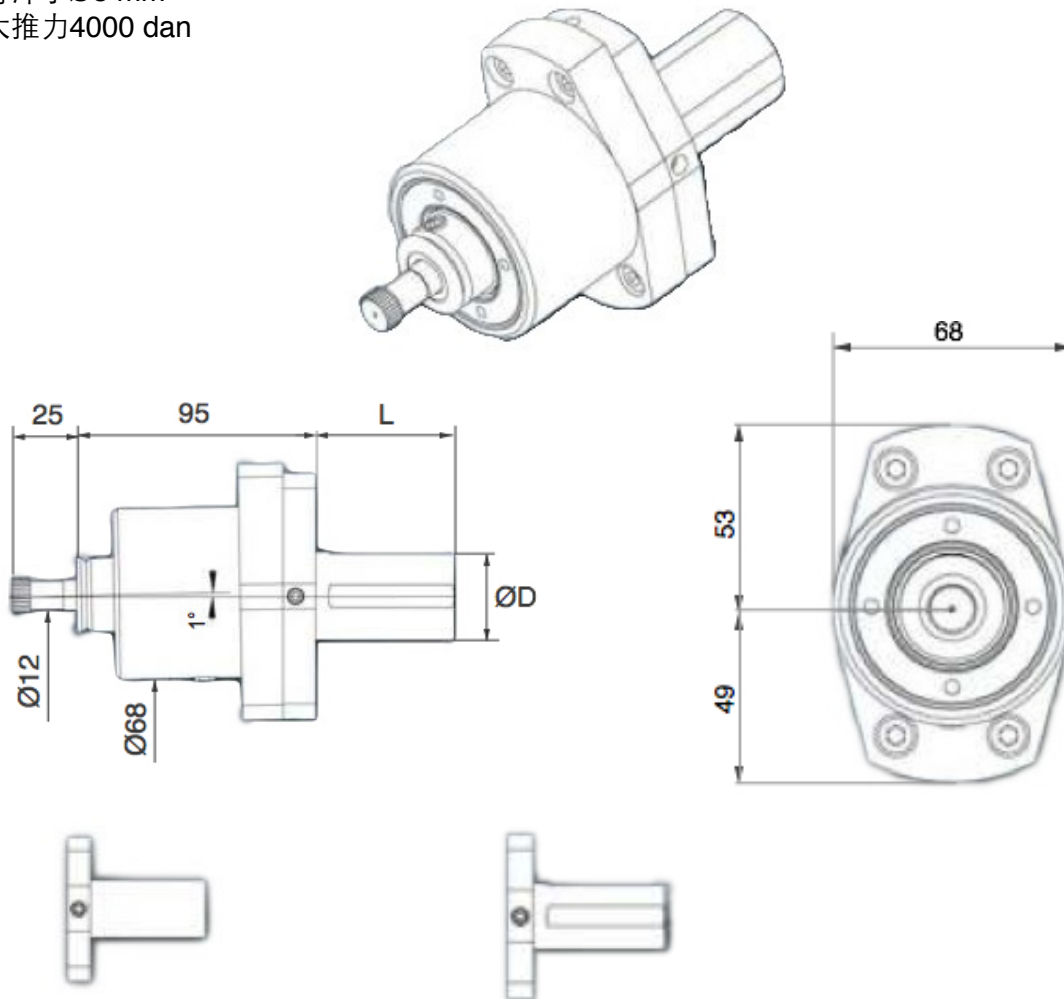

直柄

| PCM编号    | D [mm] | L [mm] |
|----------|--------|--------|
| 6190-200 | 20     | 55     |
| 6190-250 | 25     | 55     |
| 6190-254 | 25.4   | 55     |
| 6190-300 | 30     | 55     |
| 6190-317 | 31.75  | 55     |
| 6190-320 | 32     | 55     |

直柄/兩平面

| PCM编号    | D [mm] | L [mm] |
|----------|--------|--------|
| 6191-250 | 25     | 55     |
| 6191-254 | 25.4   | 55     |
| 6191-300 | 30     | 55     |
| 6191-317 | 31.75  | 55     |
| 6191-320 | 32     | 55     |
| 6191-350 | 35     | 55     |
| 6191-381 | 38.1   | 55     |
| 6191-400 | 40     | 55     |
| 6191-444 | 44.45  | 68     |
| 6191-450 | 45     | 68     |
| 6191-500 | 50     | 68     |
| 6191-508 | 50.8   | 68     |

VDI 3425-2 / DIN 69880

| PCM编号 | VDI |
|-------|-----|
| 26303 | 30  |
| 26304 | 40  |
| 26305 | 50  |

# 冲头柄 6162 系列

- 挟持冲子 $\varnothing 12$  mm
- 最大推力1200 dan

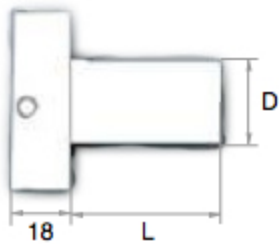
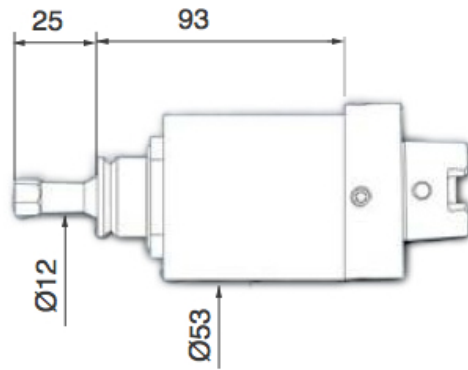

直柄/單平面

| PCM编号       | D [mm] | L [mm] |
|-------------|--------|--------|
| 6162-12-160 | 16     | 45     |
| 6162-12-190 | 19.05  | 45     |
| 6162-12-200 | 20     | 45     |
| 6162-12-250 | 25     | 45     |
| 6162-12-254 | 25.4   | 45     |
| 6162-12-320 | 32     | 45     |
| 6162-12-400 | 40     | 45     |

HSK-C

| PCM编号         | HSK-C |
|---------------|-------|
| 6162-12-HSK32 | 32    |
| 6162-12-HSK40 | 40    |

MK莫氏錐度

| PCM编号       | MK |
|-------------|----|
| 6162-12-CM2 | 2  |
| 6162-12-CM3 | 3  |

## 冲头柄 6165 系列

- 挟持冲子Ø8 mm
- 最大推力1200 dan

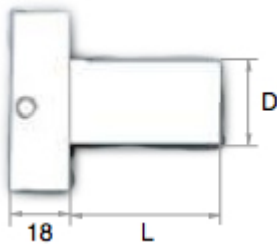
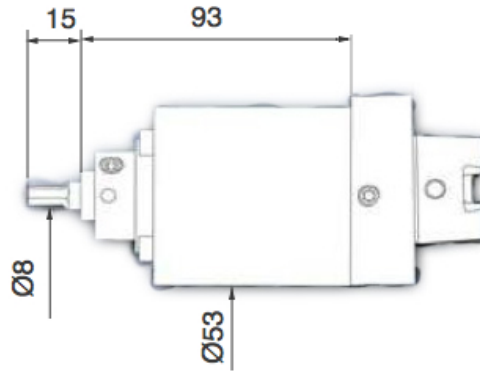

### 直柄/單平面

| PCM编号       | D [mm] | L [mm] |
|-------------|--------|--------|
| 6165-08-160 | 16     | 45     |
| 6165-08-190 | 19.05  | 45     |
| 6165-08-200 | 20     | 45     |
| 6165-08-250 | 25     | 45     |
| 6165-08-254 | 25.4   | 45     |
| 6165-08-320 | 32     | 45     |
| 6165-08-400 | 40     | 45     |

### HSK-C

| PCM编号         | HSK-C |
|---------------|-------|
| 6165-08-HSK32 | 32    |
| 6165-08-HSK40 | 40    |

### MK莫氏錐度

| PCM编号       | MK |
|-------------|----|
| 6165-08-CM2 | 2  |
| 6165-08-CM3 | 3  |

## 冲头柄 6165 系列

- 挟持冲子Ø8 mm
- 最大推力1200 dan

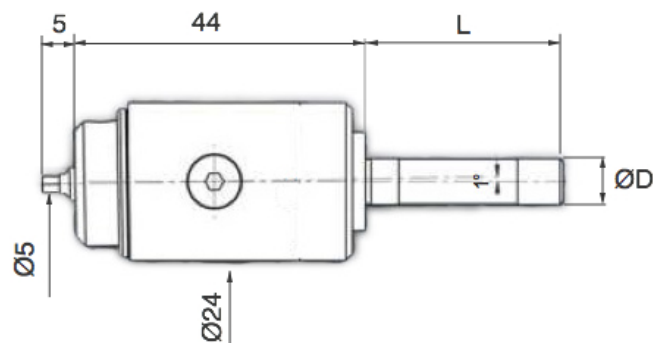

| PCM编号    | D [mm] | L [mm] |
|----------|--------|--------|
| 2150-070 | 7      | 30     |
| 2150-080 | 8      | 30     |
| 2150-100 | 10     | 38     |
| 2150-120 | 12     | 38     |
| 2150-130 | 13     | 38     |
| 2150-140 | 14     | 38     |

| PCM编号       | D [mm] | L [mm] |
|-------------|--------|--------|
| 2150-150    | 15     | 38     |
| 2150-160    | 16     | 38     |
| 2150-190    | 19.05  | 38     |
| 2150-200    | 20     | 38     |
| 2150-220-75 | 22     | 75     |



# 冲子 2110 系列

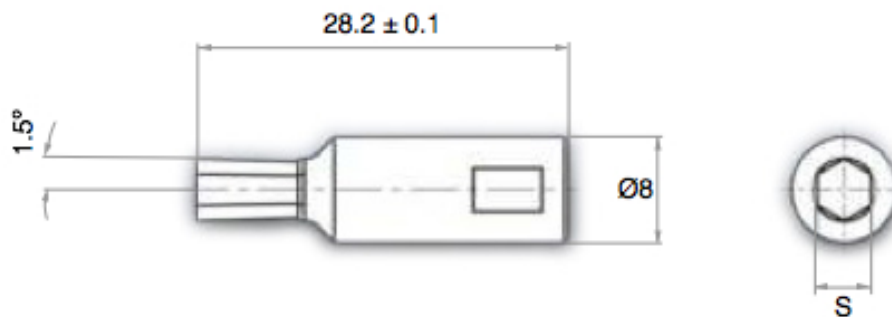

| PCM编号       | Hex [mm] | S [mm]       |
|-------------|----------|--------------|
| 2110-01.50H | 1.5 D9   | 1.538±0,007  |
| 2112H       | 2 D9     | 2.038 ±0,007 |
| 2112-5H     | 2.5 D10  | 2.553±0,007  |
| 2113H       | 3 E11    | 3.071±0.009  |
| 2114H       | 4 E11    | 4.086±0.009  |
| 2115H       | 5 E11    | 5.086±0.009  |
| 2116H       | 6 E11    | 6.084±0.011  |

| PCM编号    | Hex [mm] | S [mm]       |
|----------|----------|--------------|
| 2117H    | 7 E11    | 7.104±0.011  |
| 2118H    | 8 E11    | 8.104±0.011  |
| 2119H    | 9 E11    | 9.104±0.011  |
| 2110-10H | 10 E11   | 10.102±0.013 |
| 2110-11H | 11 E11   | 11.129±0.013 |
| 2110-12H | 12 E11   | 12.129±0.013 |
| 2110-13H | 13 E11   | 13.129±0.013 |
| 2110-14H | 14 E11   | 14.129±0.013 |

| PCM编号     | Hex [mm]  | S [mm]      |
|-----------|-----------|-------------|
| 2110-159H | 1/16" D9  | 1.625±0.007 |
| 2110-198H | 5/64" D9  | 2.022±0.007 |
| 2110-238H | 3/32" D10 | 2.434±0.007 |
| 2110-278H | 7/64" D11 | 2.851±0.007 |
| 2110-317H | 1/8" E11  | 3.261±0.009 |
| 2110-397H | 5/32" E11 | 4.054±0.009 |
| 2110-476H | 3/16" E11 | 4.848±0.009 |
| 2110-556H | 7/32" E11 | 5.642±0.009 |
| 2110-635H | 1/4" E11  | 6.454±0.011 |
| 2110-794H | 5/16" E11 | 8.041±0.011 |
| 2110-952H | 3/8" E11  | 9.629±0.011 |

# 冲子

## 6150 系列

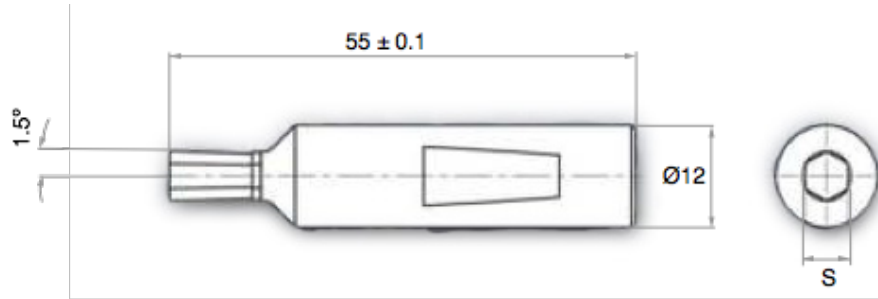

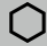
| PCM编号    |  [mm] | S [mm]       |
|----------|---|--------------|
| 6150.03H | 3 E11   | 3.071±0.009  |
| 6150.04H | 4 E11   | 4.086±0.009  |
| 6150.05H | 5 E11   | 5.086±0.009  |
| 6150.06H | 6 E11   | 6.084±0.011  |
| 6150.07H | 7 E11   | 7.104±0.011  |
| 6150.08H | 8 E11   | 8.104±0.011  |
| 6150.09H | 9 E11   | 9.104±0.011  |
| 6150.10H | 10 E11  | 10.102±0.013 |

| PCM编号    |  [mm] | S [mm]       |
|----------|---|--------------|
| 6150.11H | 11 E11  | 11.129±0.013 |
| 6150.12H | 12 E11  | 12.129±0.013 |
| 6150.13H | 13 E11  | 13.129±0.013 |
| 6150.14H | 14 E11  | 14.129±0.013 |
| 6150.16H | 16 D12  | 16.217±0.013 |
| 6150.17H | 17 D12  | 17.217±0.013 |
| 6150.18H | 18 D12  | 18.214±0.016 |
| 6150.19H | 19 D12  | 19.259±0.016 |

| PCM编号     |  [mm] | S [mm]       |
|-----------|---|--------------|
| 6150-317H | 1/8" E11  | 3.261±0.009  |
| 6150-397H | 5/32" E11   | 4.054±0.009  |
| 6150-476H | 3/16" E11   | 4.848±0.009  |
| 6150-556H | 7/32" E11   | 5.642±0.009  |
| 6150-635H | 1/4" E11  | 6.454±0.011  |
| 6150-794H | 5/16" E11   | 8.041±0.011  |
| 6150-952H | 3/8" E11  | 9.629±0.011  |
| 6150-127H | 1/2" E11  | 12.829±0.013 |
| 6150-142H | 9/16" D12   | 14.504±0.013 |
| 6150-158H | 5/8" D12  | 16.092±0.013 |

## 冲子 2151系列

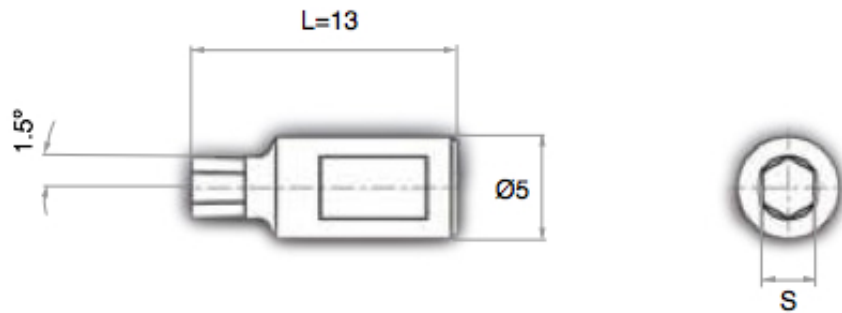

| PCM编号       | Hexagon [mm] | S [mm]       |
|-------------|--------------|--------------|
| 2151-01.50H | 1.5 D9       | 1.538±0,007  |
| 2151-02.00H | 2 D9         | 2.038 ±0,007 |
| 2151-02.50H | 2.5 D10      | 2.553±0,007  |
| 2151-03.00H | 3 E11        | 3.071±0.009  |
| 2151-03.50H | 3.5 E11      | 3.586±0.009  |
| 2151-04.00H | 4 E11        | 4.086±0.009  |

## 冲子 2122/ 6173系列

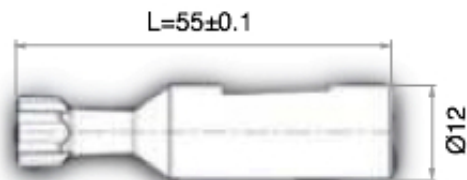
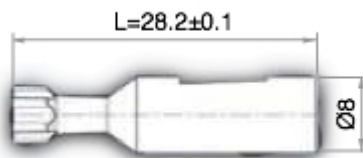

| PCM编号    | ISO 10664 (TORX) |
|----------|------------------|
| 2122-T06 | 6                |
| 2122-T08 | 8                |
| 2122-T09 | 9                |
| 2122-T10 | 10               |
| 2122-T15 | 15               |
| 2122-T20 | 20               |
| 2122-T25 | 25               |
| 2122-T30 | 30               |
| 2122-T40 | 40               |
| 2122-T45 | 45               |
| 2122-T50 | 50               |
| 2122-T55 | 55               |

| PCM编号    | ISO 10664 (TORX) |
|----------|------------------|
| 6173-T20 | 6                |
| 6173-T25 | 8                |
| 6173-T30 | 9                |
| 6173-T40 | 10               |
| 6173-T45 | 15               |
| 6173-T50 | 20               |



1

CAPITOLO  
CHAPTER

*Classic line*

**TESTE ANGOLARI - ANGLE HEADS**

*Made in Italy*



1

