

## 冲头柄 2100 系列

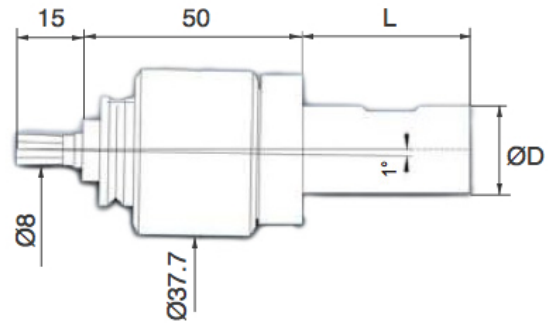
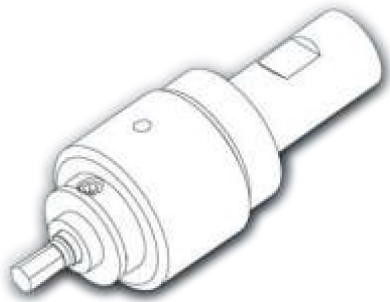

PCM编号	D [mm]	L [mm]
2100-58	15.87	38
2100-16	16	38
2102	19.05	38
2101	20	38

PCM编号	D [mm]	L [mm]
2103	25	50
2104	25.4	50
2100-22-75	22	75

- 挟持冲子Ø8 mm
- 最大推力1000 dan

## 2160 系列

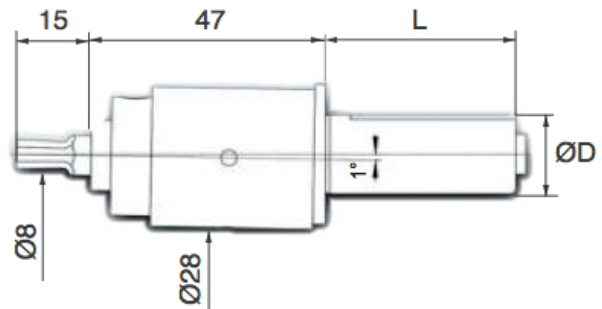
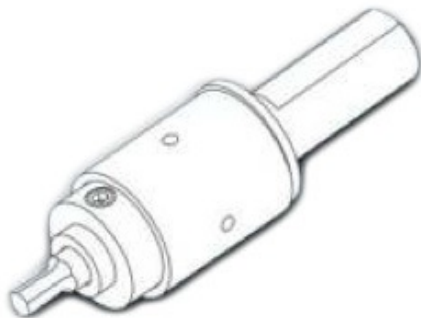

PCM编号	D [mm]	L [mm]
2160-120-038	12	38
2160-140-038	14	38
2160-158-038	15.875	38
2160-160-038	16	38

PCM编号	D [mm]	L [mm]
2160-190-100*	19.05	100
2160-200-100*	20	100
2160-220-100*	22	100
2160-250-120*	25	120
2160-254-120*	25.4	120

- 挟持冲子Ø8 mm
- 最大推力1000 dan

- \*柄部长度可自行裁切

# 冲头柄

## 6180/ 6181/ 26200 系列

- 挟持冲子Ø8 mm
- 最大推力1200 dan

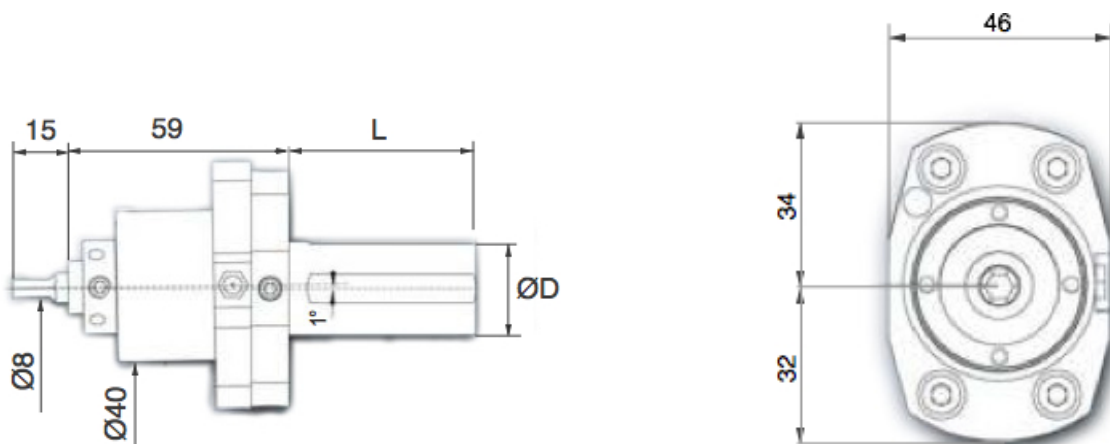
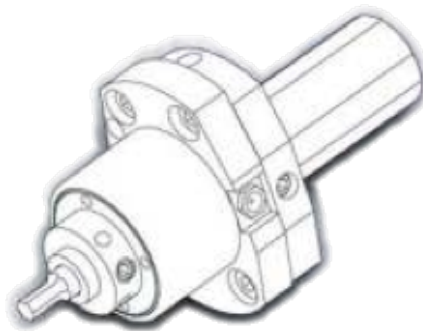

直柄

PCM编号	D [mm]	L [mm]
6180-158	15.87	40
6180-160	16	40
6180-190	19.05	40
6180-200	20	40
6180-250	25	50
6180-254	25.4	50
6180-300	30	60
6180-317	31.75	60
6180-320	32	60

直柄/兩平面

PCM编号	D [mm]	L [mm]
6181-158	15.87	40
6181-160	16	40
6181-190	19.05	40
6181-200	20	40
6181-220	22	40
6181-250	25	50
6181-254	25.4	50
6181-300	30	60
6181-317	31.75	60
6181-320	32	60

VDI 3425-2 / DIN 69880

PCM编号	VDI
26200-16	16
26201	20

# 冲头柄

## 6190/ 6191/ 26300 系列

- 挟持冲子Ø8 mm
- 最大推力4000 dan

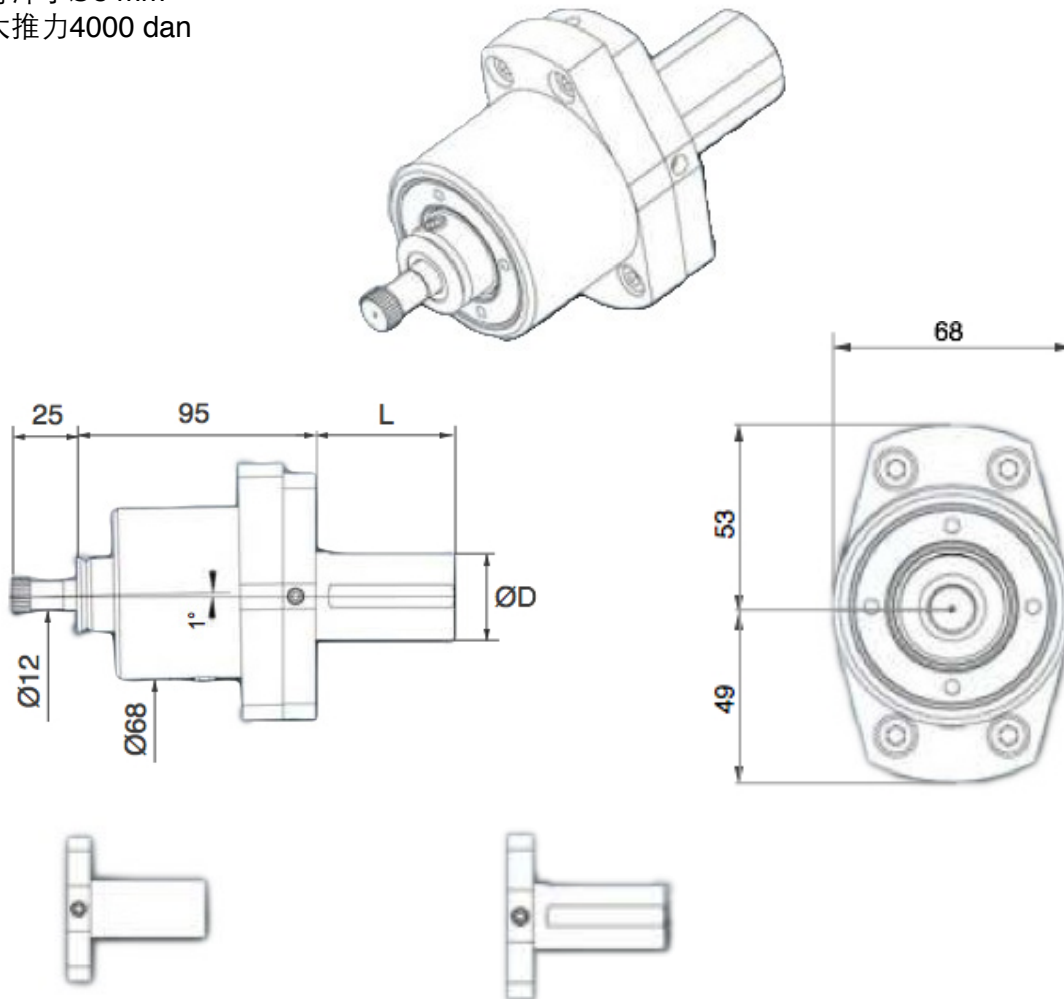

直柄

PCM编号	D [mm]	L [mm]
6190-200	20	55
6190-250	25	55
6190-254	25.4	55
6190-300	30	55
6190-317	31.75	55
6190-320	32	55

直柄/兩平面

PCM编号	D [mm]	L [mm]
6191-250	25	55
6191-254	25.4	55
6191-300	30	55
6191-317	31.75	55
6191-320	32	55
6191-350	35	55
6191-381	38.1	55
6191-400	40	55
6191-444	44.45	68
6191-450	45	68
6191-500	50	68
6191-508	50.8	68

VDI 3425-2 / DIN 69880

PCM编号	VDI
26303	30
26304	40
26305	50

# 冲头柄 6162 系列

- 挟持冲子 $\varnothing 12$  mm
- 最大推力1200 dan

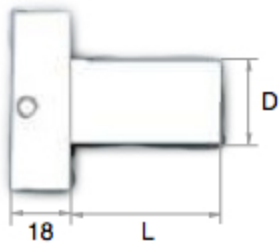
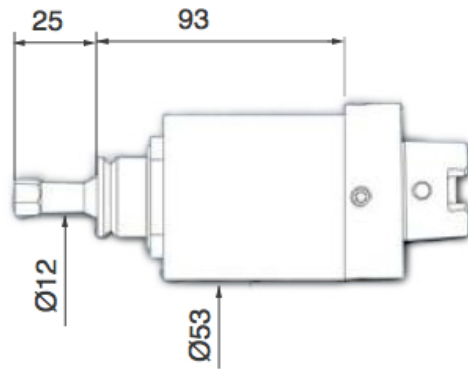

直柄/單平面

PCM编号	D [mm]	L [mm]
6162-12-160	16	45
6162-12-190	19.05	45
6162-12-200	20	45
6162-12-250	25	45
6162-12-254	25.4	45
6162-12-320	32	45
6162-12-400	40	45

HSK-C

PCM编号	HSK-C
6162-12-HSK32	32
6162-12-HSK40	40

MK莫氏錐度

PCM编号	MK
6162-12-CM2	2
6162-12-CM3	3

## 冲头柄 6165 系列

- 挟持冲子Ø8 mm
- 最大推力1200 dan

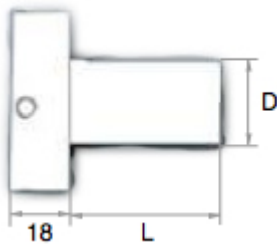
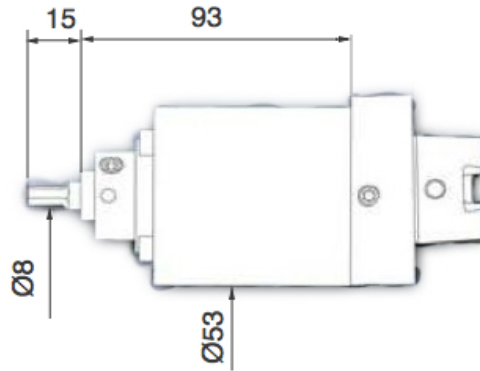

直柄/單平面

PCM编号	D [mm]	L [mm]
6165-08-160	16	45
6165-08-190	19.05	45
6165-08-200	20	45
6165-08-250	25	45
6165-08-254	25.4	45
6165-08-320	32	45
6165-08-400	40	45

HSK-C

PCM编号	HSK-C
6165-08-HSK32	32
6165-08-HSK40	40

MK莫氏錐度

PCM编号	MK
6165-08-CM2	2
6165-08-CM3	3

## 冲头柄 6165 系列

- 挟持冲子Ø8 mm
- 最大推力1200 dan

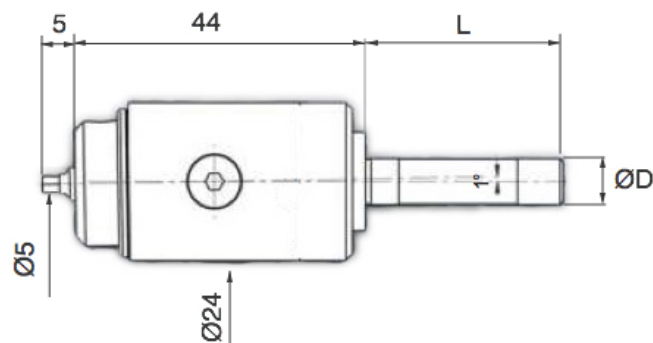

PCM编号	D [mm]	L [mm]
2150-070	7	30
2150-080	8	30
2150-100	10	38
2150-120	12	38
2150-130	13	38
2150-140	14	38

PCM编号	D [mm]	L [mm]
2150-150	15	38
2150-160	16	38
2150-190	19.05	38
2150-200	20	38
2150-220-75	22	75

# 冲子 2110 系列

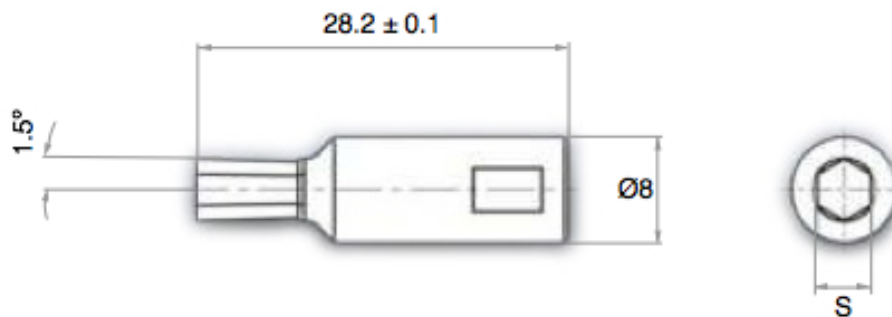

PCM编号	Hex [mm]	S [mm]
2110-01.50H	1.5 D9	1.538±0,007
2112H	2 D9	2.038 ±0,007
2112-5H	2.5 D10	2.553±0,007
2113H	3 E11	3.071±0.009
2114H	4 E11	4.086±0.009
2115H	5 E11	5.086±0.009
2116H	6 E11	6.084±0.011

PCM编号	Hex [mm]	S [mm]
2117H	7 E11	7.104±0.011
2118H	8 E11	8.104±0.011
2119H	9 E11	9.104±0.011
2110-10H	10 E11	10.102±0.013
2110-11H	11 E11	11.129±0.013
2110-12H	12 E11	12.129±0.013
2110-13H	13 E11	13.129±0.013
2110-14H	14 E11	14.129±0.013

PCM编号	Hex [mm]	S [mm]
2110-159H	1/16" D9	1.625±0.007
2110-198H	5/64" D9	2.022±0.007
2110-238H	3/32" D10	2.434±0.007
2110-278H	7/64" D11	2.851±0.007
2110-317H	1/8" E11	3.261±0.009
2110-397H	5/32" E11	4.054±0.009
2110-476H	3/16" E11	4.848±0.009
2110-556H	7/32" E11	5.642±0.009
2110-635H	1/4" E11	6.454±0.011
2110-794H	5/16" E11	8.041±0.011
2110-952H	3/8" E11	9.629±0.011

# 冲子 6150 系列

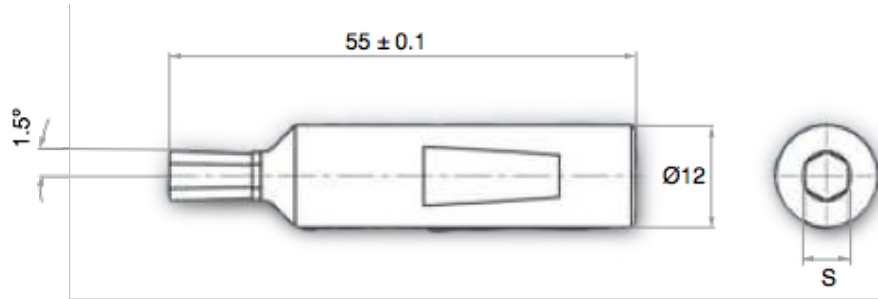

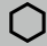
PCM编号	 [mm]	S [mm]
6150.03H	3 E11	3.071±0.009
6150.04H	4 E11	4.086±0.009
6150.05H	5 E11	5.086±0.009
6150.06H	6 E11	6.084±0.011
6150.07H	7 E11	7.104±0.011
6150.08H	8 E11	8.104±0.011
6150.09H	9 E11	9.104±0.011
6150.10H	10 E11	10.102±0.013

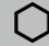
PCM编号	 [mm]	S [mm]
6150.11H	11 E11	11.129±0.013
6150.12H	12 E11	12.129±0.013
6150.13H	13 E11	13.129±0.013
6150.14H	14 E11	14.129±0.013
6150.16H	16 D12	16.217±0.013
6150.17H	17 D12	17.217±0.013
6150.18H	18 D12	18.214±0.016
6150.19H	19 D12	19.259±0.016

PCM编号	 [mm]	S [mm]
6150-317H	1/8" E11	3.261±0.009
6150-397H	5/32" E11	4.054±0.009
6150-476H	3/16" E11	4.848±0.009
6150-556H	7/32" E11	5.642±0.009
6150-635H	1/4" E11	6.454±0.011
6150-794H	5/16" E11	8.041±0.011
6150-952H	3/8" E11	9.629±0.011
6150-127H	1/2" E11	12.829±0.013
6150-142H	9/16" D12	14.504±0.013
6150-158H	5/8" D12	16.092±0.013

## 冲子 2151系列

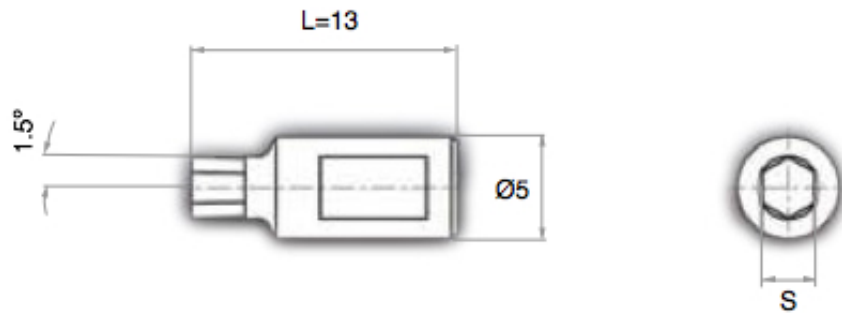

PCM编号	Hexagon [mm]	S [mm]
2151-01.50H	1.5 D9	1.538±0,007
2151-02.00H	2 D9	2.038 ±0,007
2151-02.50H	2.5 D10	2.553±0,007
2151-03.00H	3 E11	3.071±0.009
2151-03.50H	3.5 E11	3.586±0.009
2151-04.00H	4 E11	4.086±0.009

## 冲子 2122/ 6173系列

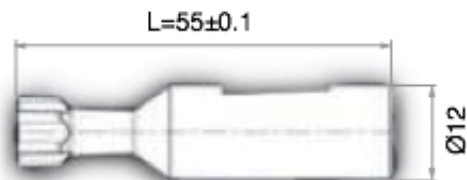
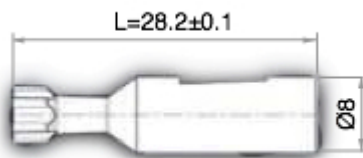

PCM编号	ISO 10664 (TORX)
2122-T06	6
2122-T08	8
2122-T09	9
2122-T10	10
2122-T15	15
2122-T20	20
2122-T25	25
2122-T30	30
2122-T40	40
2122-T45	45
2122-T50	50
2122-T55	55

PCM编号	ISO 10664 (TORX)
6173-T20	6
6173-T25	8
6173-T30	9
6173-T40	10
6173-T45	15
6173-T50	20